

Features

APPLICATIONS: The Hersey® TRuRead™ Remote Visual Read Counter provides remote on demand visual read capability for all Hersey Meters equipped with the Translator Encoder Register. The TRuRead can be mounted up to 300 feet from the meter and is ideal for situations where the meter is inaccessible or it is inconvenient to take direct readings. The TRuRead allows easy visual monitoring of water consumption for any purpose. Simply pass a wand across the dial face of the TruRead for a real time display of the electronic output of the Translator register.

No special tools are required for installation. It can be mounted easily with two screws through its installation bracket and locked into place with the exclusive, invisible Hersey locking pin. The mounting screws are secured inside the housing after installation to prevent tampering. For convenience and flexibility, a secondary AMR device such as a touchpad or RF meter interface unit may be connected to the TRuRead remote to provide additional AMR reading capabilities. Connections are easily made with two sets of screw terminals on the back of the register. The TRuRead remote easily retrofits to any Hersey Meter equipped with a Translator remote register.

DESCRIPTION: The TRuRead remote automatically interrogates the Translator™ Encoder Register's exact number wheel locations every hour and displays the data on a large, liquid crystal display. The electronic reading value output of the Translator Register and all system's messages are easy to read in large alphanumeric characters.

CONSTRUCTION: The TRuRead remote is a self-contained, permanently sealed, electronic unit housed in a neutral color, tamper protected, thermoplastic box with a hinged lid. The TRuRead remote features Hersey's "L" shaped triple seal gasket, heat-treated, domed register glass and copper bottom, which are currently used in all Hersey PD Meter Registers. All electronic components were carefully chosen to compliment each other and provide the highest degree of performance in hostile outdoor environments.

ENVIRONMENT: The TRuRead remote is designed to withstand exterior weather conditions including sun, rain, sleet and snow with temperatures ranging from -40°F to +180°F.

POWER SUPPLY: The TRuRead remote uses integral lithium batteries for power to provide an operational life of up to 15 years. When the battery is exhausted, simply dispose of the unit properly.

CONFORMANCE TO STANDARDS: The TRuRead remote conforms to AWWA Std. C706



Materials and Specifications

- **MODEL** TRuRead™, Part Number C6551G
- **COMPATIBILITY** All Hersey Translator Registers
- **DISPLAY** LCD display 9/32"
- **POWER SUPPLY** Lithium non-rechargeable; non-replaceable with up to 15 year life
- **TEMPERATURE RANGE** -40F to +180F (Protect Meter from Freezing)
- **CABLE CONNECTION**22 AWG 3-strand wire
- **OPTIONS** Wand for On Demand Reads Part # A13047

TRuRead Remote Register and Housing Components

TRuRead Rear Connection View

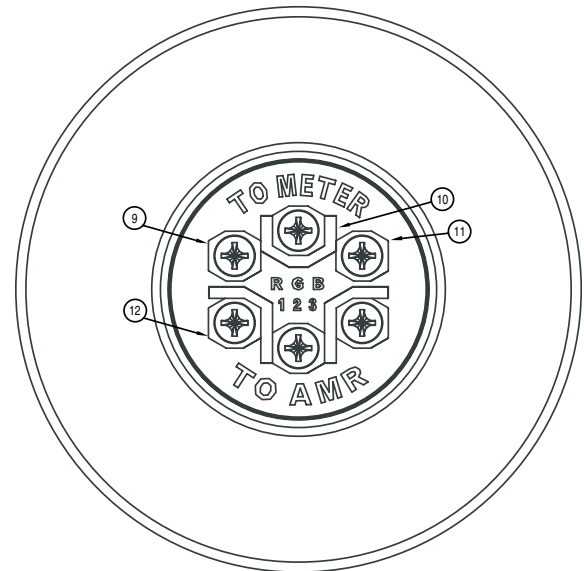
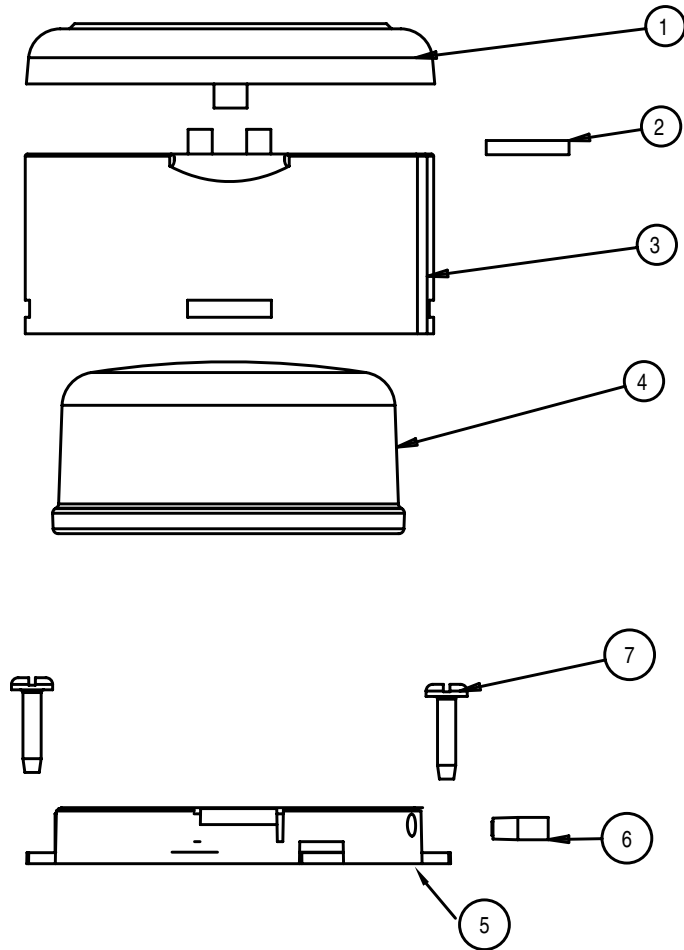

The top three screws are labeled “TO METER” and are color coded red, green and black. The screw positions are also labeled R, G and B to designate the color sequence. The color of wires from the Translator Register should correspond to the screw color and letter designation on the TruRead.

The bottom three screws are labeled “TO AMR” and are numbered 1, 2 and 3. These screws permit the connection of a secondary AMR device such as a touchpad. Consult the installation instructions for each device to determine the proper wire connections.

Ref	Description	Part Number
1	RegisterLid	C5768-2
2	Roll Pin	AS41122
3	Register Housing	C5769-2
4	TRuRead Remote Counter	C6551
5	Mounting Bracket	C6551G
6	Locking Pin	A126582
7	Mounting Screws (2)	AS5912 (2)
8	TRuRead Housing Kit	C6551KIT (includes 1, 2, 3, 5, 6, 7)
9	Red Connection Screw	981971
10	Green Connection Screw	981972
11	Black Connection Screw	981973
12	Silver Connection Screw	98197 (3)
13	On Demand Wand (not shown)	A13047